

ENQUIRY NO:		DATE:	
--------------------	--	--------------	--

CONTACT DETAILS

Company Name		Project Name	
Address		Project Address	
Email ID		Site Contact Person	
Telephone No		Contract Number	

CAR LIFT TECHNICAL PARAMETERS

1.		2.	
Model	SFJ-Q101 SFJ-Z101	Floors	
Quantity	Nos	Service Stop Passengers	
Carrying Capacity (kg)	3000 5000 other	Machine Location	
Speed (m/s)	0.25 0.5 other	Floor to Floor Height	m
Power Supply		Total Travel Height	m [≤ 15 m]
Frequency (Hz)		Power Voltage (V)	
		Lightning Voltage (V)	

MODELS

1.
SFJ-Q101



2.
SFJ-Z101



CAR LIFT PARAMETERS & LAYOUT

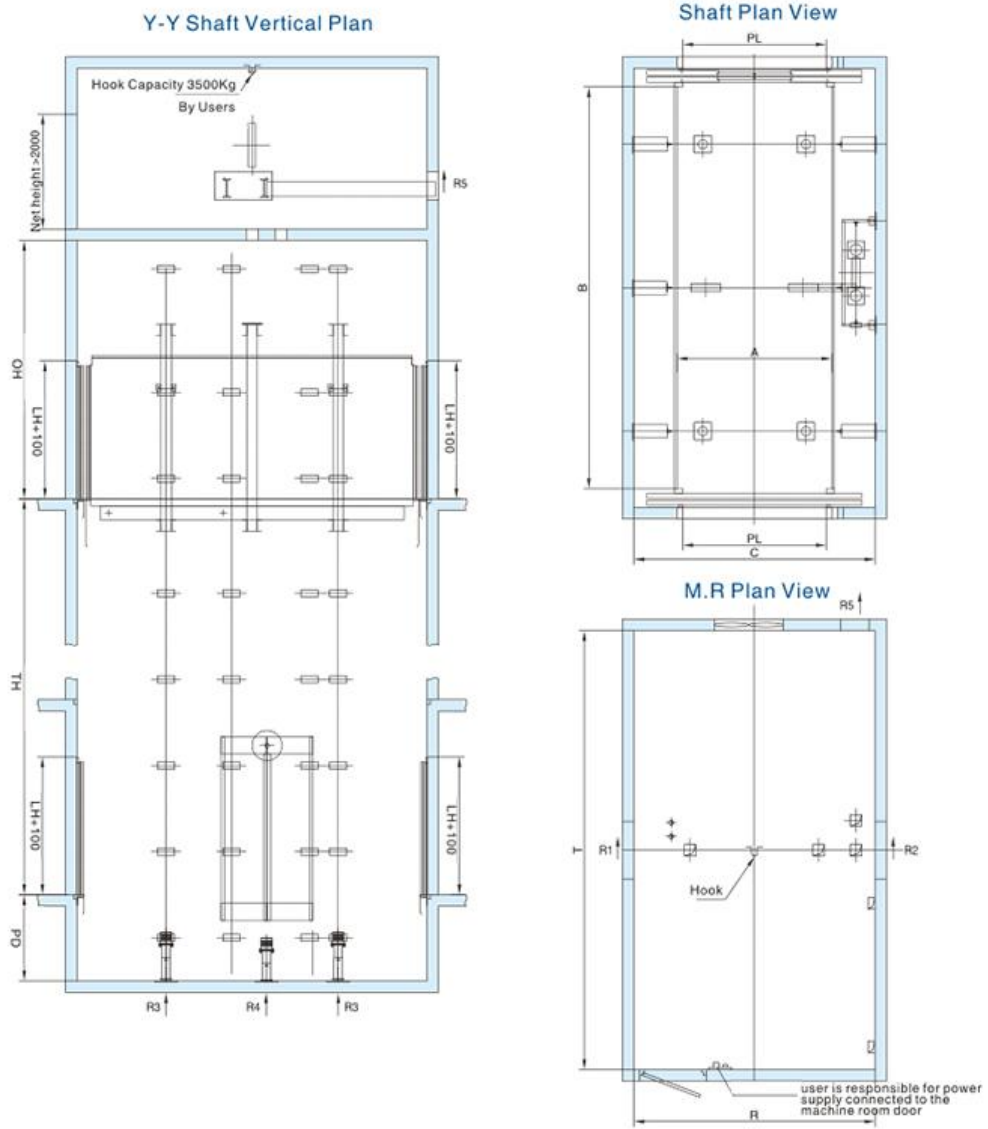

Carrying capacity (kg)	Speed (m/s)	Car Size		Shaft Size		E(mm) Gate Width	F(mm) Gate Height	M. R.			O(mm) Top layer altituded	P(mm) Bottom depth
		A(mm) Width	B(mm) Depth	C(mm) Width	D(mm) Depth			H(mm) Heiht	R(mm) Width	TR(mm) Depth		
3000	0.25	2500	5500	4150	6150	2500	2100	3000	4500	6150	4400	1600
3000	0.50											
5000	0.25	2500	6500	4150	7150	2500	2100	3000	4500	7150	4400	1600
5000	0.50											

* The schematic drawing of civil work is for reference only